

PREPARED FOR:
 1172250 BC Ltd.
 201 - 814 Goldstream Avenue
 Victoria, BC V9B 2X7
 Tel (250) 588-9425

<http://www.trufflesgroup.com>

*Measured Area: 3,657 s.f.
 Exterior Area: 803 s.f.

1172250 BC LTD.
 2333 GOVERNMENT STREET
 VICTORIA, BC

BUILDING 2

SECOND FLOOR
 (As Measured: November 2018)

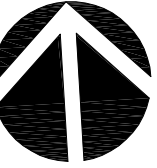

FLOOR PLAN

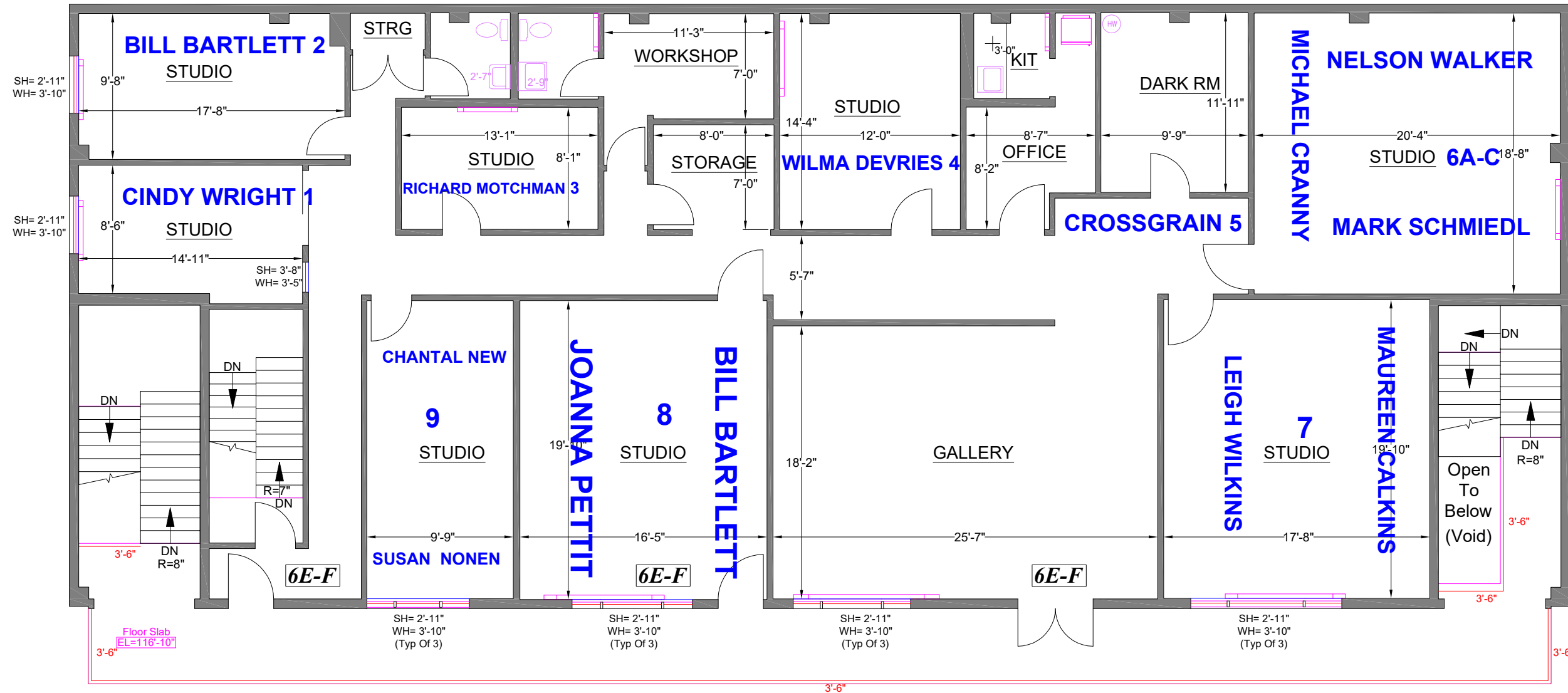

SCALE: 1/8" = 1' - 0"



TEL: (888) 393-6655
 FILE: 18-559-02

ELEVATION LEGEND

Spot Height (Above Finished Floor): + X'-X"
 Sill Height (Above Finished Floor): AFF= X'-X"
 Window Height: WH= X'-X"

Survey Accuracy: +/- 0.07 %

*Measured Area represents the footprint of the floor, and is used solely for billing purposes. It is NOT to be used for leasing purposes.

Note: All dimensions shown are rounded to the nearest inch, for informational purposes only. All measurements are recorded to 1/8" accuracy as documented in the final CAD drawing supplied.

LASERTECH® is a registered US trademark of Lasertech® Floorplans Ltd. Copyright 1998 Lasertech® Floorplans Ltd., All Rights Reserved